

TUBING CLAMPS

PAC Stainless stocks two different clamp options in a wide variety of sizes. The versatile STAUFF® clamps and the simple, yet effective Gang Clamps. All of these clamps are available to meet your tubing support and bundling needs. Whether your clamp requirements call for single-line or multi-line runs in a stainless steel or polymer construction, PAC Stainless has the appropriate clamp for your application.

STAUFF® CLAMPS

STAUFF® Clamps have become well-known in many onshore and offshore applications as the industry standard for tube, pipe and hose support clamping systems. With the addition of their anti-corrosion technology (ACT) clamp, STAUFF® continues to provide solutions for high-vibration and corrosive environments and are proven to have excellent weathering resistance even under extreme conditions. Please contact us for any of your STAUFF® Clamp needs.

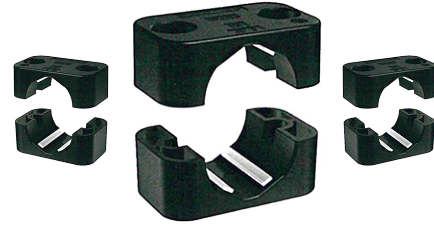

GANG CLAMPS

These clamps can accommodate anywhere from 1 to 12 tubes and custom sizes can be manufactured. All tubing Gang Clamps are fabricated in 316 stainless steel with a minimum 16 gauge thickness. Mounting holes are drilled to facilitate the use of 1/4" threaded fasteners. Back plates are offered with the multi-line clamps; Single clamps come as a one piece solution. Yoke and Duplex clamps are also available.

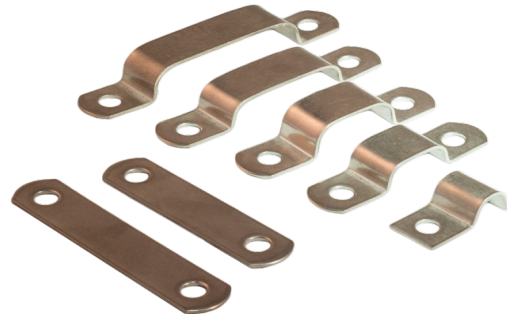

GANG CLAMP SIZES IN STOCK SIZES

OD	Number of Tubes in Run											
	1	2	3	4	5	6	7	8	9	10	11	12
1/4"	✓	✓	✓	✓	✓	✓	✓	✓	✓	✓	✓	✓
3/8"	✓	✓	✓	✓	✓	✓	✓	✓	✓	✓	✓	✓
1/2"	✓	✓	✓	✓	✓	✓	✓	✓	✓	✓	✓	✓
5/8"	✓	✓	✓	✓	✓	✓						
3/4"	✓	✓	✓	✓								
1"	✓											